



Free **Transport**

Nearest **Landmarks**

- Wapda Town Roundabout (2.3 km)
- Emporium Mall (6.1 km)
- Expo Center (6.0 km)
- Alfatah (2.8 km)
- McDonalds (6.5 km)
- Gourmet Bakery (2.7 km)

**Looking forward to
welcoming you!**

Ms Sumera Naveed

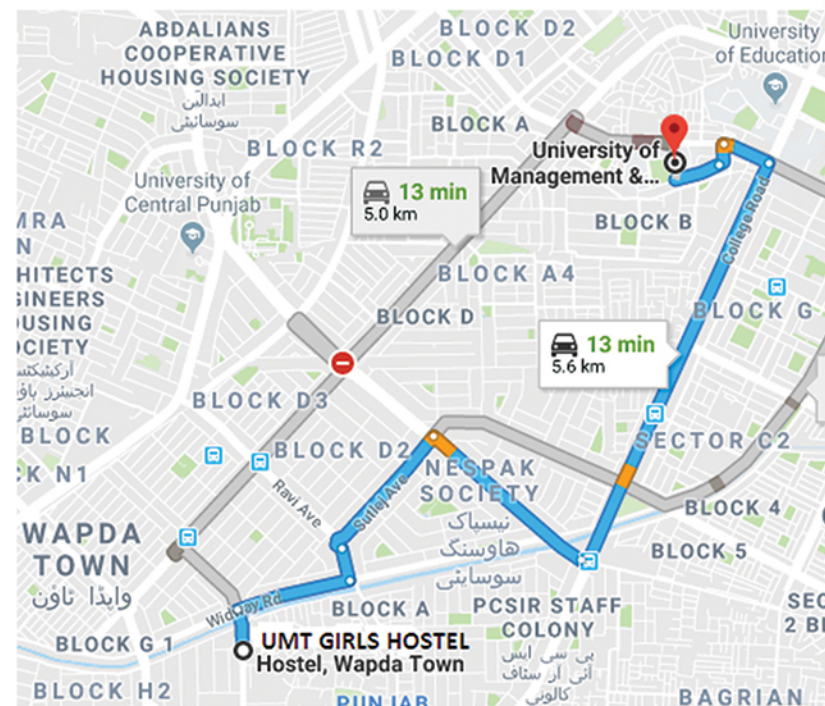

UMT GIRLS HOUSING

Wapda Town
Lahore



UMT Housing Wapda Town

152-153 Block H1, Wapda Town, Lahore

Tel: +92 42 35412580

Warden Cell No: 03054440267

Email: warden.fsh@umt.edu.pk

Deputy Warden Cell No: 03054440701

Website: www.umt.edu.pk



University of Management
and Technology

Make the Right Choice!

Introduction

UMT offers an extensive range of degree programs, providing educational prospects to students living in far-flung areas, by assisting them in their acquisition of higher education. UMT understands the needs of these students who are away from their families and loved ones, and hence aims at providing them with the best housing experience. UMT offers accommodation facilities to its female student body, understanding their need of a secure, protected and comfortable milieu, where they can make new friends and feel at home. UMT has acquired new accommodation at Wapda Town, Lahore, for female students within a reasonable budget and has been designed keeping in mind the essentials of a balanced, comfortable and well-equipped hostel life. This housing facility encompasses state-of-the-art-facilities including well-furnished rooms, air-conditioners, generators, high speed internet, recreational room, indoor sports area and a well-designed cafeteria. Located around the most animated and respectable neighborhood, the UMT Girls Housing provides female students easy access to the university and major areas of the city.

135+
PhD Faculty
from Renowned
Universities

**Over
110**
Accredited
Programs

96%
Student
Satisfaction

**Ranked
W4
University by
HEC**

20:1
Student
Faculty Ratio

**17,000+
Alumni
13,000+
Students**

50+
International
Linkages

60+
Clubs and
Societies

91%
Placement
in First Six Months



UMT GIRLS HOUSING

Wapda Town

Service Type	Type of Charges	Charges
Admission Fee	One time	Rs. 10,000/-
Security (Refundable)	One time	Rs. 5,000/-
Generator Charges	6 Months	Rs. 5,000/-

Service Type	Type of Charges	Charges
*Sharing Room	6 Months	Rs. 59,999/- (Rs 10,000 Per Month)
*Single/Independent Room	6 Months	Rs. 150,000/-

**Accommodation will be reserved for one year.*

Other Charges		
Student can use electrical appliances as additional cost has to be paid with hostel dues.		
Air Conditioner	Monthly	As Per Actual Units
Air Cooler	Monthly	Rs. 2,000/-
Food (All Inclusive for 3 Meals)	Monthly	Rs. 6,000/-

Facilities		
Furnished Rooms Bed with Mattress Store Room Attached Washroom Cupboard Room Size 14/12	Housekeeping Cleanliness Healthy Environment Medical Facility First Aid Ambulance	Parking Car Parking Hot and Cold Water 24-Hour Facility Repair and Maintenance Electrician Plumber Carpenter
Security 24 Hour High Alert Security CCTV Monitoring System	Internet High Speed	Extracurricular Activities Newspapers and Magazines Badminton Court Basketball Court Volleyball Court
Generator Facility 24-Hour Facility	Cafeteria Healthy Food Quality Food Hygienic Food	
Transportation Every Hour (Free)		

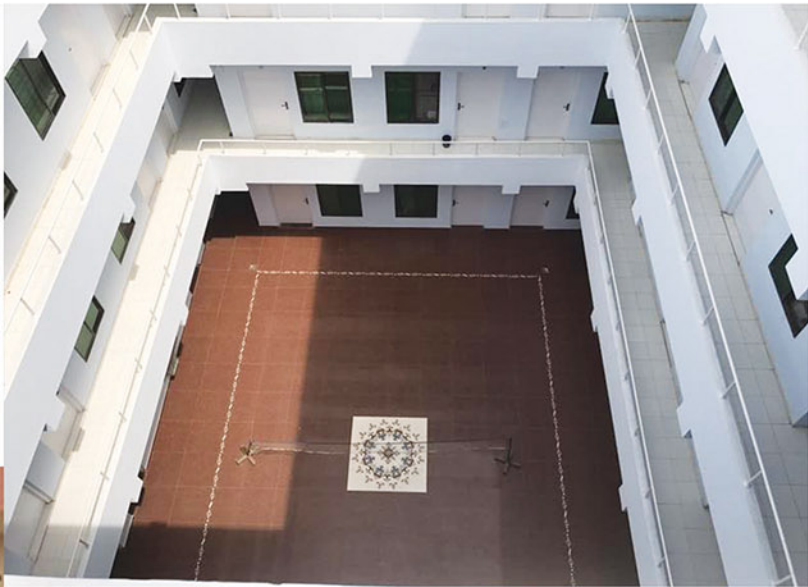



Life at UMT Housing

Fun-filled activities keep you active

We understand the pertinence of sports activities which provides numerous prospects for fun-filled hours here such as badminton, cricket, board games, etc.



Best dining facilities and a well-planned menu

We provide you with the best dining facilities, where the menu is well thought-out and designed in accordance with your nutritional requirements, leading to a healthy lifestyle.



Making new friends- building connections for a lifetime

The housing allows you to meet new people belonging to diversified backgrounds, enabling you to build up new connections and make friends for a lifetime.



Easy access to University through transportation facility

We provide transportation facilities to the housing residents, which makes traveling to and fro to university and housing, much easier and convenient.



Academic edge over your peers

Living in housing provides you an academic edge over your peers, as you get the opportunity to study in groups and learn from one another, in a safe and conducive environment.

Recreational Facilities

Students need a break from their hectic study schedules, which can be provided by organizing different recreational activities. We provide the facility of a living area or a TV lounge to our residents, so that they can gather with their friends and spend quality time watching their favorite programs.



High-quality and well-equipped accommodations/rooms

We have a state-of-the-art building, ensuring that our residents enjoy high-quality and well-equipped accommodation that caters to their needs and requirements. We pay special emphasis towards the maintenance of cleanliness, which is carried out by our domestic staff regularly.

Away from homes

We realize that being away from your homes is extremely difficult and challenging on mental as well as emotional levels. We will try our level best to provide you a homely environment, where you can make new friends, feel safe and settle in comfortably.

